

T9 , T10

- PL** Instrukcja montażu
- D** Montageanleitung
- GB** Assembly instructions
- ES** Instrucciones de instalación
- FR** Instructions de montage
- CZ** Montážní návod
- UA** Інструкція монтажу
- HU** Összeszerelési útmutató
- SK** Montážny návod
- RU** Инструкция по монтажу
- IT** Istruzioni di montaggio
- RO** Instructiuni de asamblare
- TR** Montaj talimatı
- NL** Handleiding voor de montage

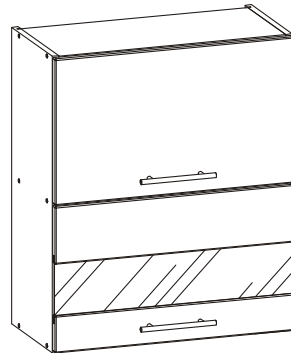

T9
600X300X720

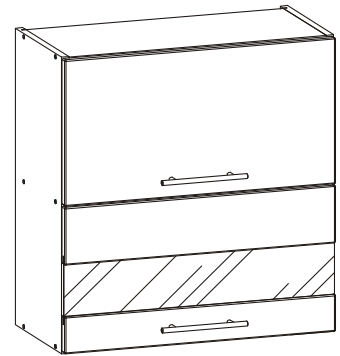

T10
800X300X720

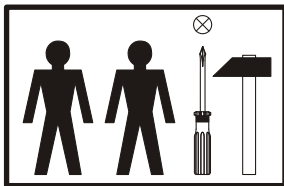

1

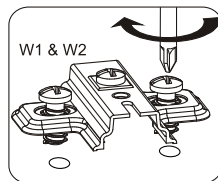
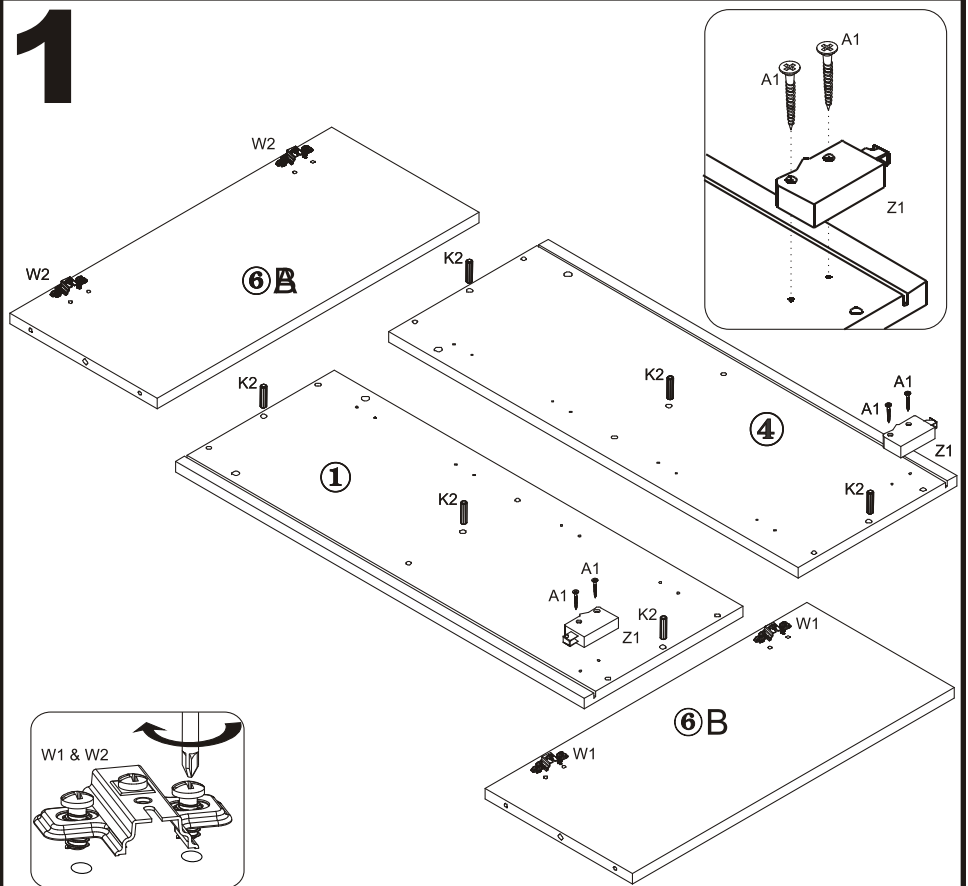
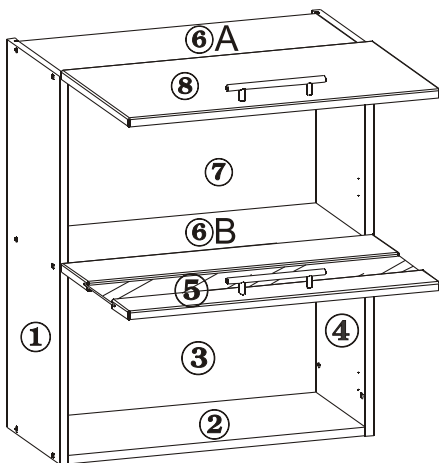

Do szafek górnych Tiffany ścianka tylna "3:7" pakowana jest w paczkę razem z frontem (paczka 2/2).

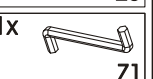
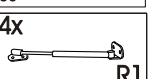
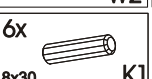
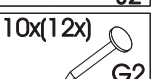
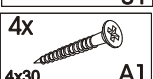
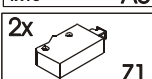
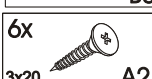
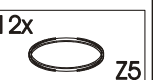
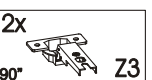
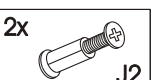
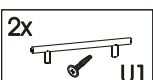
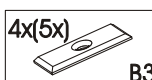
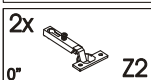

2

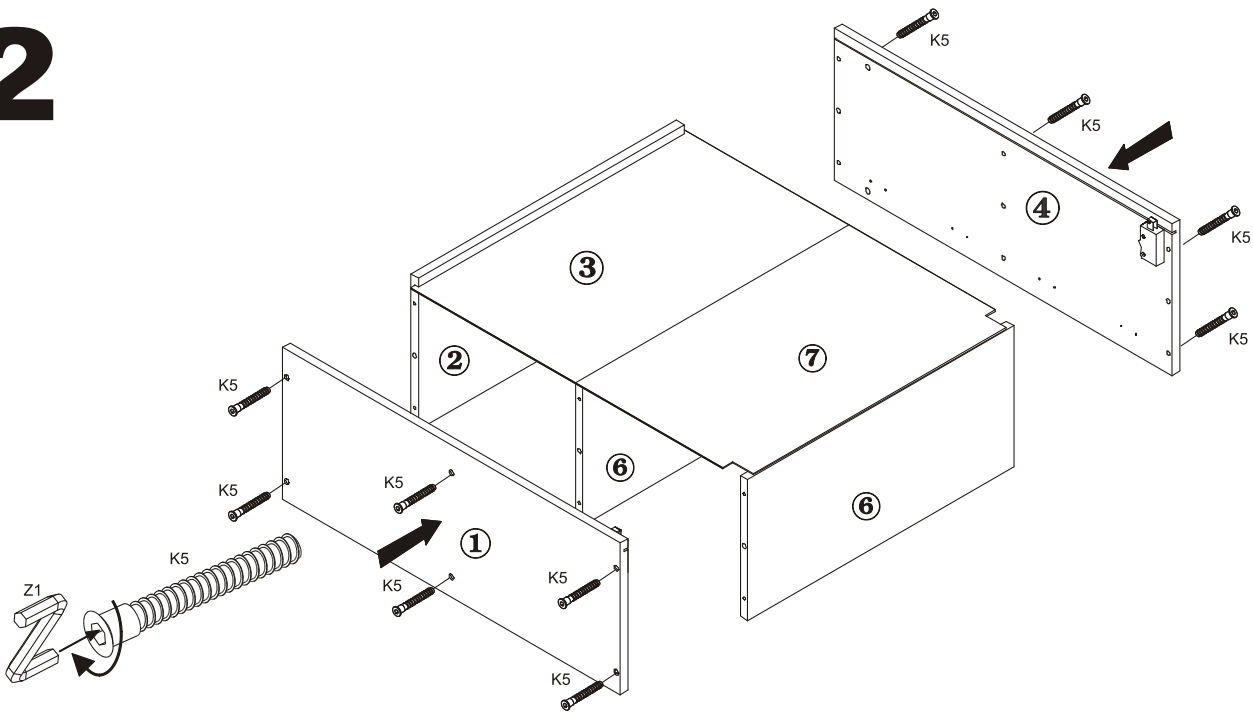

3

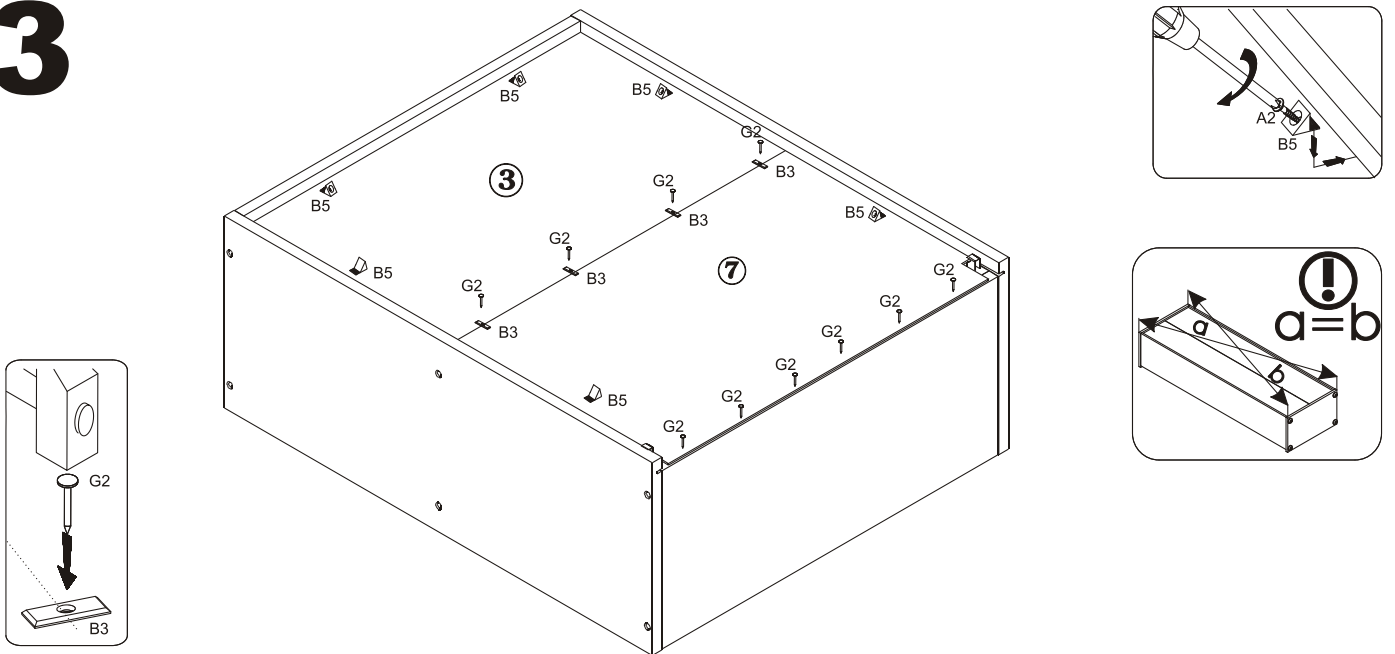

4

